

# JAMES EDWARD

Comprehensively Cared For



Westacott Close

, London, N19 3LF

£3,000 Per Month



# Westacott Close



## Description

Spacious four bedroom house, located just a short walk to Archway Station, HEATING AND HOT WATER included in rent.

- Four Bedrooms
- Spacious Kitchen/Dinner
- Furnished
- 10 Minute Walk to Archway Station
- No Communal Living Room
- Private Garden
- HEATING AND HOT WATER BILL INCLUDED
- Available Mid July
- Close to Local Amenities





# Floor Plan

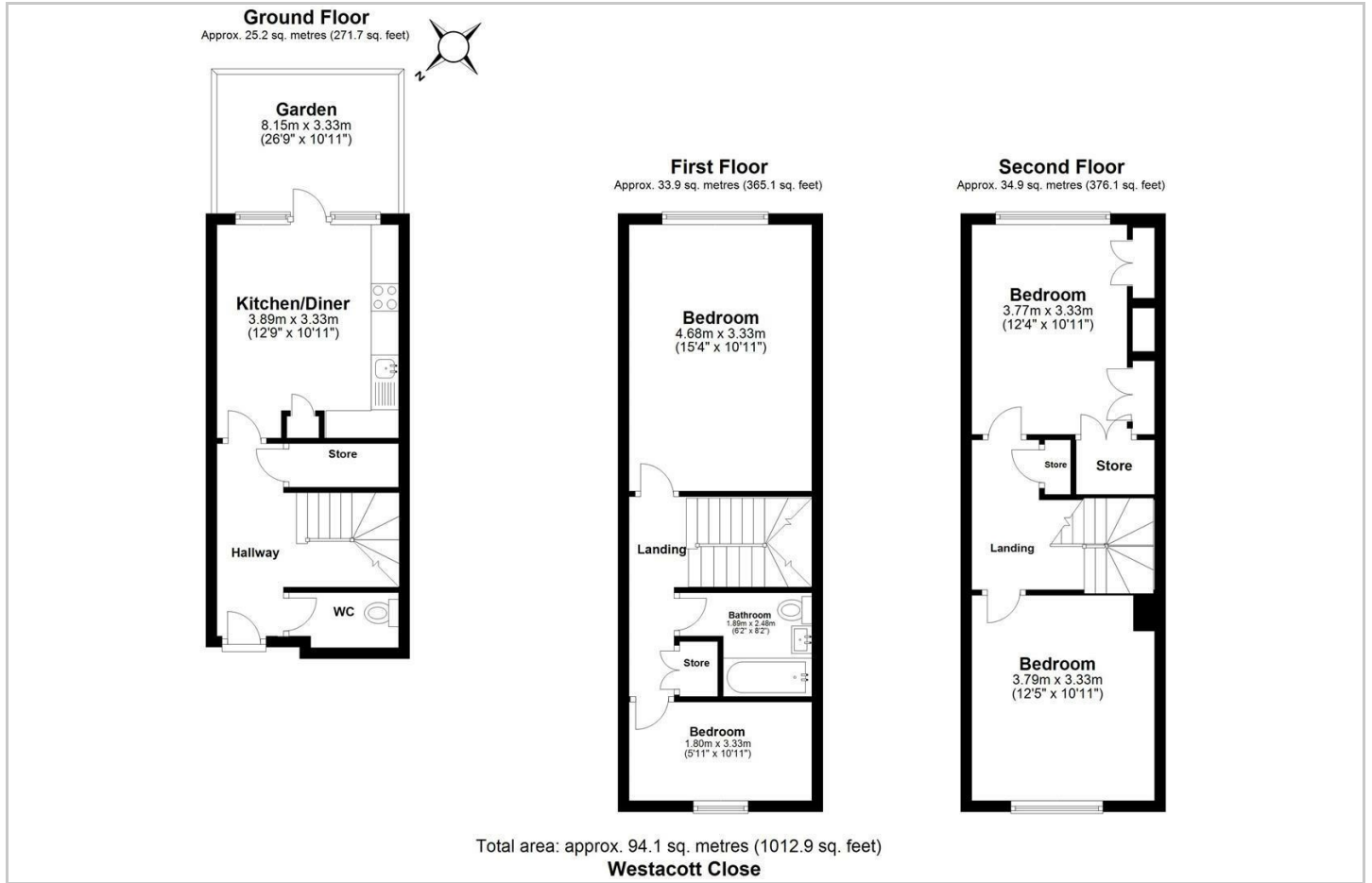

## Area Map

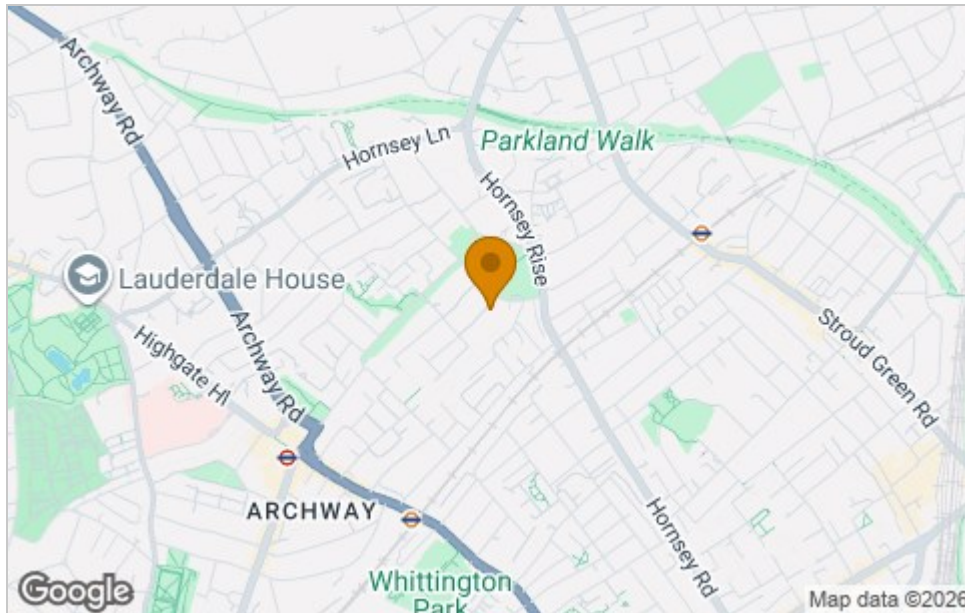

## Viewing

Please contact our James Edward Office on 020 7952 5197 if you wish to arrange a viewing appointment for this property or require further information.

## Energy Efficiency Graph

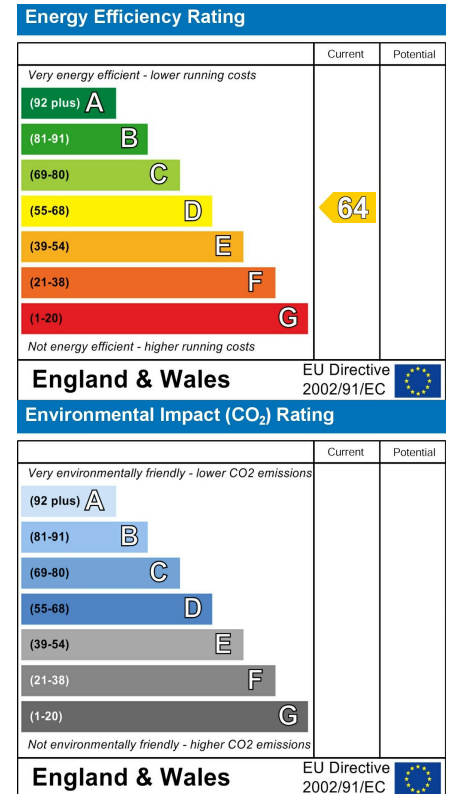

These particulars, whilst believed to be accurate are set out as a general outline only for guidance and do not constitute any part of an offer or contract. Intending purchasers should not rely on them as statements of representation of fact, but must satisfy themselves by inspection or otherwise as to their accuracy. No person in this firm's employment has the authority to make or give any representation or warranty in respect of the property.

100 Highbury Park, London, N5 2XE

Tel: 020 7952 5197 Email: [info@jamesedwardproperties.co.uk](mailto:info@jamesedwardproperties.co.uk) <https://www.jamesedwardproperties.co.uk>